

THIRD ANGLE PROJECTION

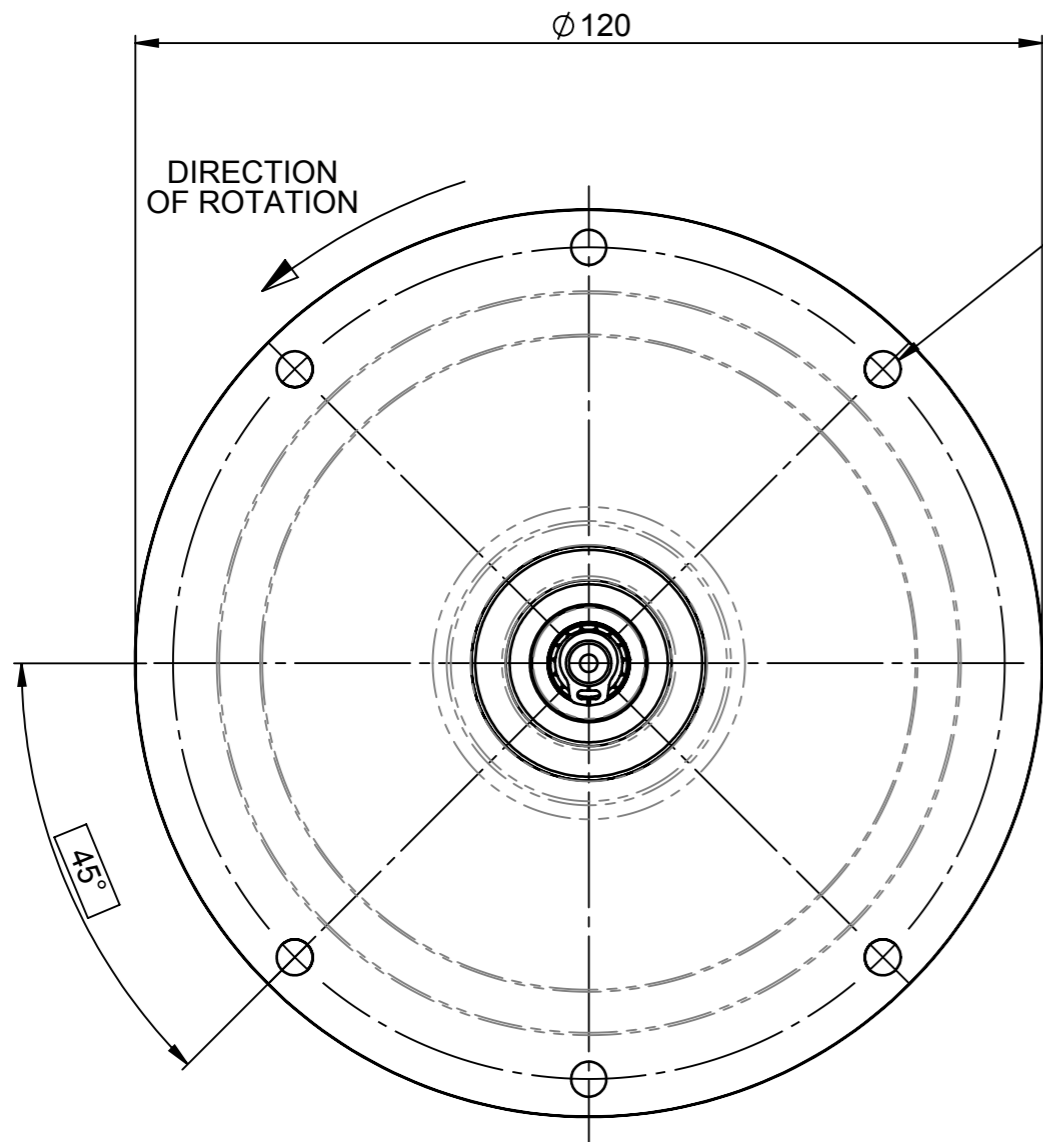

4 HOLES $\phi 4.75$
EQUISPACED
AS SHOWN ON 110.0 PCD

$\phi \pm 0.15$

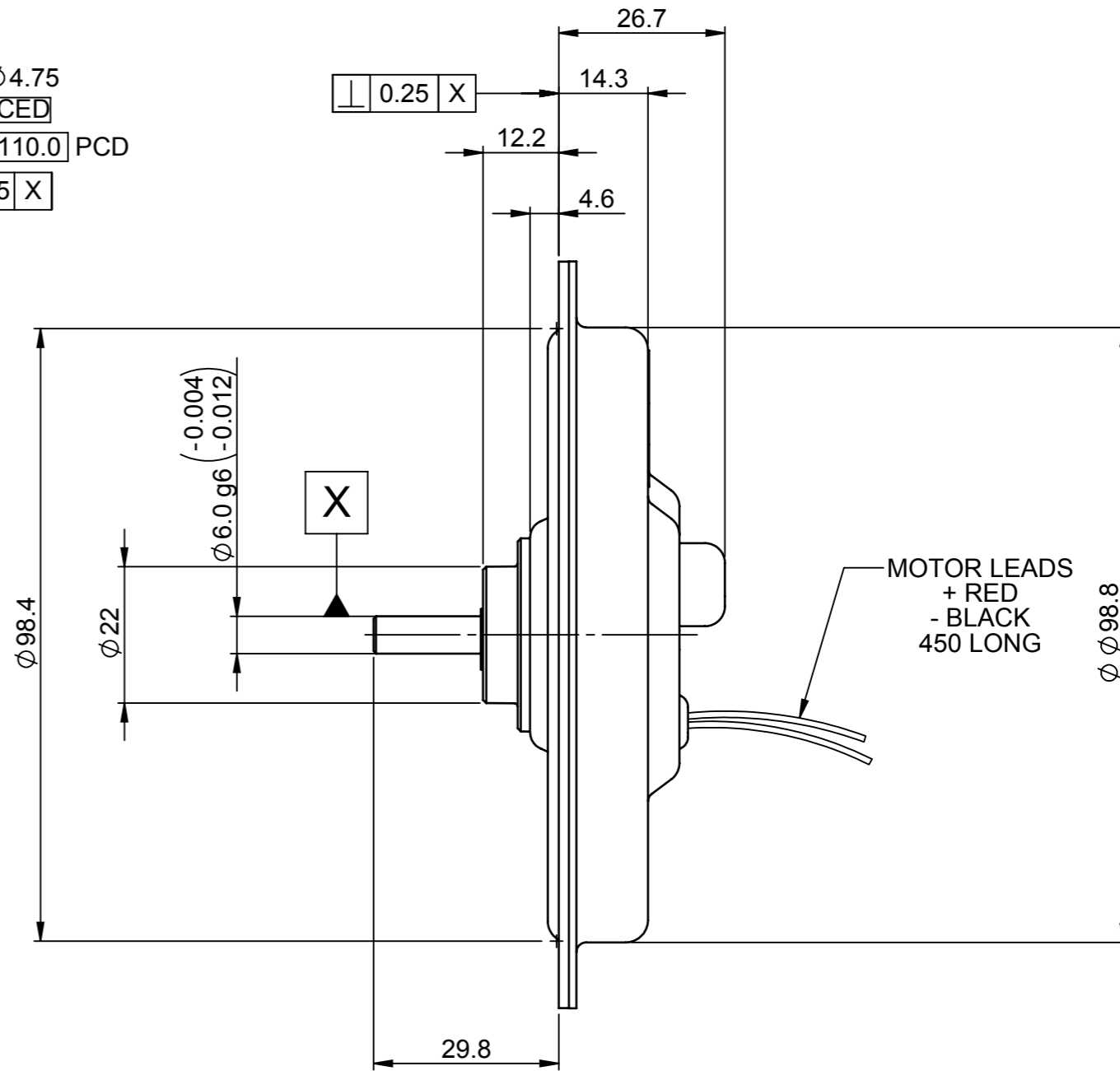

MOTOR RATINGS.

VOLTAGE.....22.5 VDC
CURRENT.....6.9 Amps
TORQUE.....30.0 Ncm
SPEED.....3000 r.p.m
POWER.....94 Watts

MOTOR CONSTANTS.

VOLTAGE.....Ke 5.0 V/1000 r.p.m
TORQUE.....Kt 4.8 Ncm/ Amp
DAMPING.....Kd 0.50 Ncm / 1000 r.p.m
FRICTION.....Tf 1.2 Ncm
TERMINAL RESISTANCE.....1.1 Ohm

NOTES:

- ELECTRICAL TEST SPEC. No. 095

GENERAL ASSEMBLY DETAILS
SEE DRG. 539793

| | | | | | | | | | | | | | | |
|--------------------------------|------------|--------|------|----------|---|------------|---------------------------------|--------------------------|---------------|-----------------|---|-------------------------------------|--|--|
| LAST CHANGE DETAIL \triangle | | | | | KEY CHARACTERISTICS IDENTIFIED BY THE FOLLOWING SYMBOL \diamond | | TOLERANCES UNLESS STATED | | DIMENSIONS mm | | UNLESS OTHERWISE STATED CHAMFER OR RADII 0.13 (0.005") MAX. REMOVE BURRS & SHARP EDGES. DIMENSIONS APPLY AFTER PLATING | | PRINTED MOTOR WORKS Ltd, ALTON, HAMPSHIRE. GU34 2QW. UK | |
| ISS. | DATE | CR No. | ZONE | INITIALS | DRAWN BY | DATE | 0. ± 0.4 | ESTIMATED MASS 632.37 | SCALE 1:1 | MATERIAL N/A | FINISH N/A | TITLE CUSTOMER OUTLINE DRG. GPN9 | | |
| 04 | 11/10/2011 | CR3817 | | GB | G. BELL | 12/08/2010 | 0.0 ± 0.1 | | | | | | | |
| 03 | 17/08/2010 | CR3445 | | GB | CHECKED BY | DATE | 0.00 ± 0.05 | | | | | DRAWING NUMBER 005049 | | |
| | | | | | RB | 12/08/2010 | ANGULAR ± 0.5° | | | | | | | |
| | | | | | APPROVED BY | DATE | SURFACE FINISH 1.6/ ∇ | | | | | SHEET 1 OF 1 | | |

© PRINTED MOTOR WORKS LIMITED
 THIS DRAWING, ENGINEERING REPORT OR DOCUMENT IS COPYRIGHT AND PROPERTY IS RESERVED THEREIN AND THE INFORMATION CONTAINED THEREIN IS CONFIDENTIAL. THIS DRAWING, ENGINEERING REPORT OR DOCUMENT AND INFORMATION MAY NOT BE REPRODUCED OR COMMUNICATED TO A THIRD PARTY OR USED FOR ANY PURPOSE OTHER THAN THAT FOR WHICH IS SUPPLIED WITHOUT THE PRIOR WRITTEN CONSENT OF THE COMPANY.