

© PRINTED MOTOR WORKS LIMITED
 THIS DRAWING, ENGINEERING REPORT OR DOCUMENT IS COPYRIGHT AND PROPERTY IS RESERVED THEREIN AND THE INFORMATION CONTAINED THEREIN IS CONFIDENTIAL. THIS DRAWING, ENGINEERING REPORT OR DOCUMENT AND INFORMATION MAY NOT BE REPRODUCED OR COMMUNICATED TO A THIRD PARTY OR USED FOR ANY PURPOSE OTHER THAN THAT FOR WHICH IS SUPPLIED WITHOUT THE PRIOR WRITTEN CONSENT OF THE COMPANY.

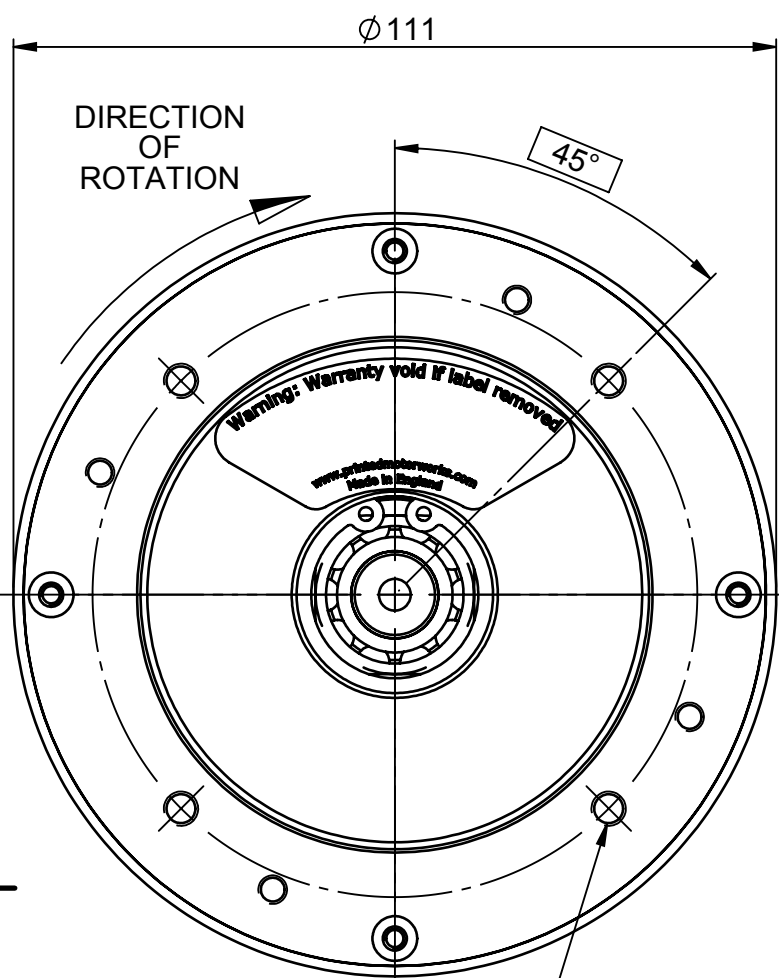
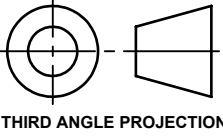

ϕ Ø 0.15 X
 4 HOLES M5 x 0.8-6H
 6 MIN FULL THREAD
 EQUISPACED
 ON 88.0 PCD

MOTOR RATINGS.

VOLTAGE.....22 VDC
 CURRENT.....8.7 Amps
 TORQUE.....36 Ncm
 SPEED.....3000 r.p.m
 POWER.....113 Watts

MOTOR CONSTANTS.

VOLTAGE.....Ke 4.9 V/1000 r.p.m
 TORQUE.....Kt 4.7 Ncm/ Amp
 DAMPING.....Kd 0.56 Ncm / 1000 r.p.m
 FRICTION.....Tf 2.8 Ncm
 TERMINAL RESISTANCE.....0.85 Ohms

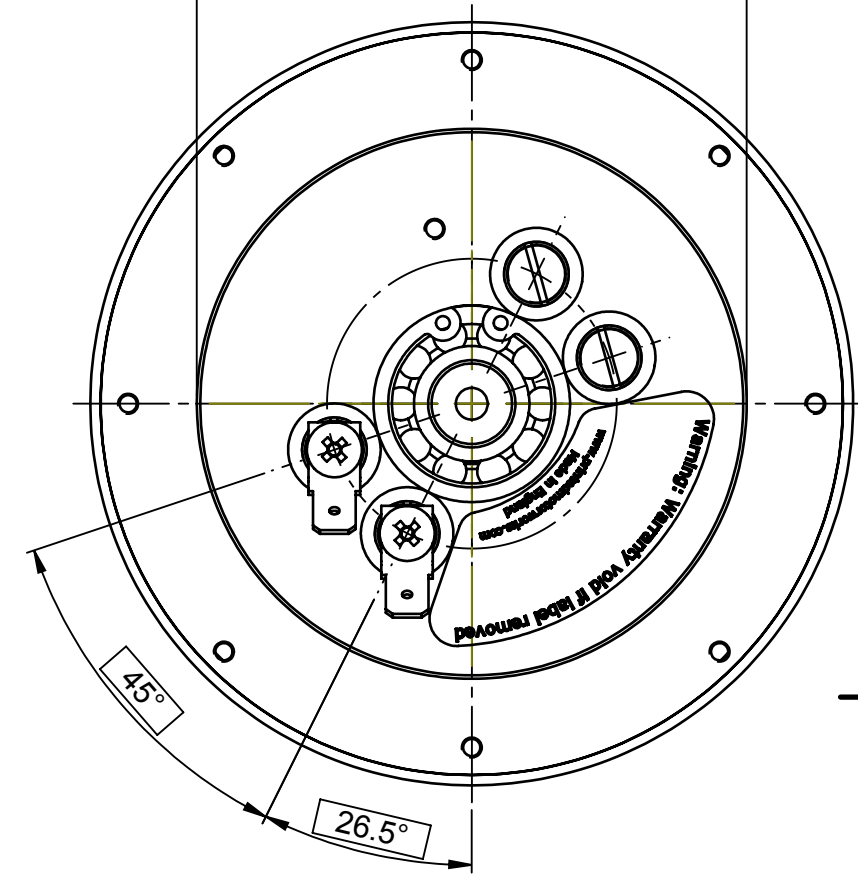
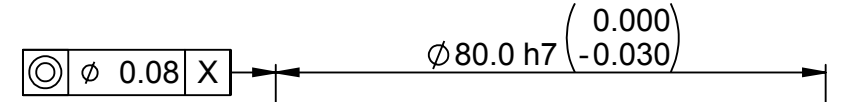
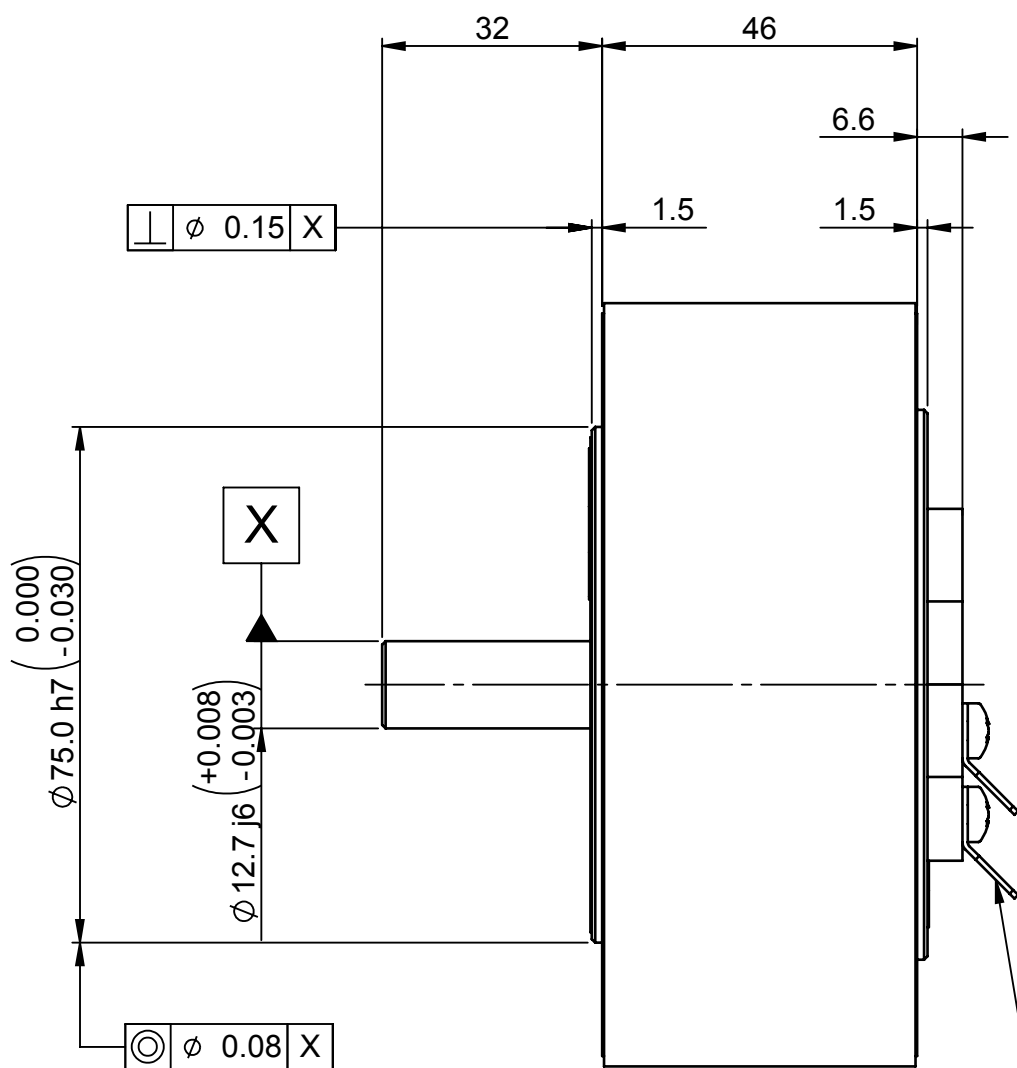

NOTES:

- ELECTRICAL TEST SPEC. No. 009
- MAX SHAFT ENDPLAY 0.1mm UNDER A REVERSAL OF 25N THRUST
- MAX RADIAL LOAD ALLOWABLE 140N AT RATED SPEED

GENERAL ASSEMBLY DRG.
5310164

LAST CHANGE DETAIL \triangle					PART MARKING INDELIBLY MARK ON PART No. WHERE MARKED		TOLERANCES UNLESS STATED		DIMENSIONS mm		UNLESS OTHERWISE STATED CHAMFER OR RADII 0.13 (0.005") MAX. REMOVE BURRS & SHARP EDGES. DIMENSIONS APPLY AFTER PLATING		PRINTED MOTOR WORKS Ltd, ALTON, HAMPSHIRE. GU34 2QW. UK		
ISS.	DATE	CR No.	ZONE	INITIALS	DRAWN BY G. BELL	DATE 27/03/2012	0. ± 0.4	0.0 ± 0.1	ESTIMATED MASS 1993.61	MATERIAL N/A		TITLE CUSTOMER OUTLINE DRAWING GM9			
10	27/03/2012	CR3957		GB	CHECKED BY RB	DATE 27/03/2012	0.00 ± 0.05	ANGULAR ± 0.5°	SCALE 1:1.1	FINISH N/A		DRAWING NUMBER 002000		SHEET 1 OF 1	
					APPROVED BY	DATE	SURFACE FINISH 1.6/ ∇			DO NOT SCALE. IF IN DOUBT ASK. BS 8888					