

**NOTES: (UNLESS OTHERWISE SPECIFIED)**

- ALL DIMENSIONS ARE IN mm OTHERWISE NOTED.
- LINEAR SPECIFICATION:**  
 LINEAR STROKE: 25.0+1.0/-0 mm  
 FORCE CONSTANT: 15.5 N/AMP  
 PEAK FORCE: 35 N @ 2.5 AMPS (24 VDC)  
 CONTINUE FORCE : 24 N @ 2.0 AMPS (24 VDC)  
 COIL DC RESISTANCE: 7 OHMS @ 22°C  
 COIL INDUCTANCE: 1.1 mH @ 1 kHz  
 ENCODER RESOLUTION: 0.5, 1, 5.0 MICRON-METER  
 ENCODER ACCURACY: ±5 COUNTS
- MOVING MASS: TBD
- TOTAL MASS: TBD
- OPERATING TEMPERATURE: -10°C TO +85°C

SIGNATURE NEEDED FOR ORDER APPROVAL  
 SIGN \_\_\_\_\_ DATE \_\_\_\_\_  
 APPROVAL NOT RECEIVED WITHIN  
 48 HOURS MAY AFFECT DELIVERY

REVISIONS				
REV	DATE	ECN	DESCRIPTION	APP
A	9/10/03	2808	SEE ECN	GK
B	12/22/03	2897	CHANGED BODY, SEE ECN	SEK
C	10/13/04	3354	SEE ECN ***	CAW

**DB-28P PINOUT**

1	(L) PH. A+
2	(L) PH. B+
3	(L) PH. Z+
4	NC
5	NC
6	1/D RTN
7	(R) PH. B+
8	(R) PH. A+
9	(R) PH. Z+
10	(L) PH. A-
11	(L) PH. B-
12	(L) PH. Z-
13	NC/(R) HOME
14	LIMIT +
15	LIMIT -
16	(R) PH. B-
17	(R) PH. A-
18	(R) PH. I-
18	+5VDC
20	5V RTN
21	(L) COIL +
22	(L) COIL -
23	(L) COIL +
24	(L) COIL -
25	(R) MOTOR -
26	(R) MOTOR +

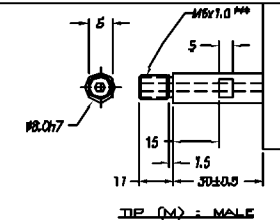
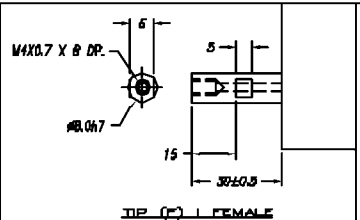
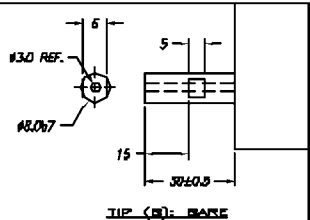
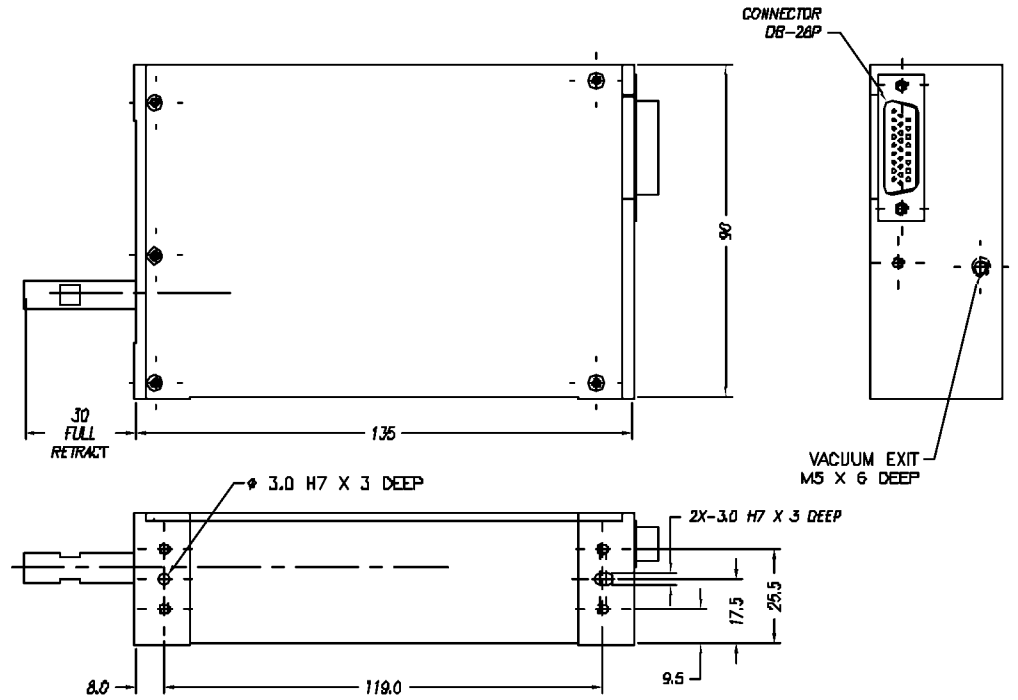
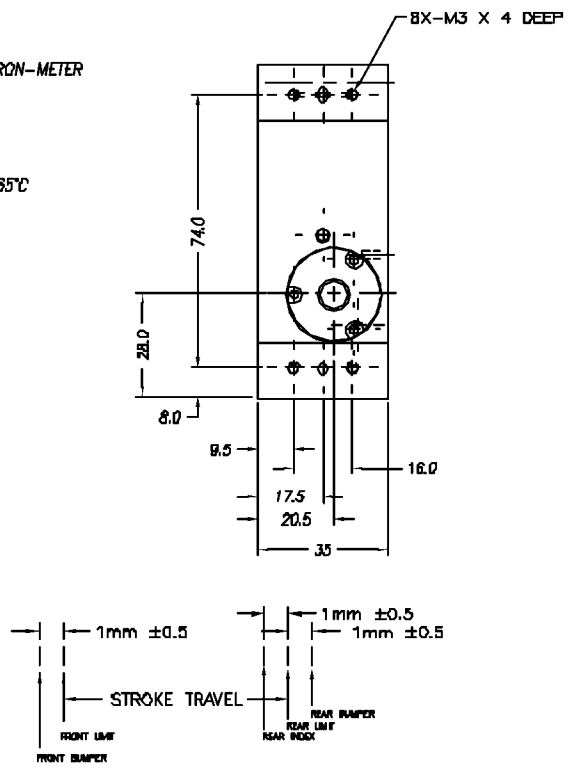

TOLERANCES ARE:	
X.	± 0.50
X.X	± 0.1
X.XX	± 0.05
X.XXX	±
ANGULARITY	± 0.1°
CONCENTRIC	± 0.01
ROUNDNESS	± 0.05
EDGE BREAK	0.2 MAX
CHAMFER	0.1 MAX

MATERIAL: ALUMINUM 6061-T6				REF. NUMBER	
<b>SMAC</b>				LAL35-025-6	
HEAT TREAT: FC	DESIGNED BY: G. KAMBARA	DATE: 8/10/03	CHECKED BY:	DATE:	CONTRACT: STD
MACHINE FINISH: DEEP	DRAWN BY: G. KAMBARA	DATE: 9/10/03	APPROVED BY:	DATE:	SHEET NUMBER: 1 OF 1
EXEPT NOTELL	PART NAME: LAL35-025-6				REVISION: C
PROTECTIVE FINISH: ELECTROLESS NICKEL	SCALE: NONE	DWG SIZE: B	PART NUMBER: LAL35-025-6	REVISION: C	
SPEC. NUMBER	DO NOT SCALE DWG				

FILE NAME: LAL35-025-6\_C