

NOTES: 1.

| TORQUE | PLAIN | BLACK |
|----------------------|----------|----------|
| [INCHES] mm | PART NO. | PART NO. |
| [0] Lb-in 0.0 Nm | 28-000 | 28-100 |
| [3.9] Lb-in 0.44 Nm | 28-004 | 28-104 |
| [6.9] Lb-in 0.78 Nm | 28-008 | 28-108 |
| [10.8] Lb-in 1.22 Nm | 28-012 | 28-112 |
| [13.9] Lb-in 1.57 Nm | 28-016 | 28-116 |
| [17.8] Lb-in 2.01 Nm | 28-020 | 28-120 |
| [20.8] Lb-in 2.35 Nm | 28-024 | 28-124 |
| [24.7] Lb-in 2.79 Nm | 28-030 | 28-130 |

2. TORQUE TOLERANCE: $\pm 20\%$
3. LIFE: 50,000 CYCLES WHEN DUTY CYCLE IS LESS THAN 10% AND ROTATIONAL SPEED IS LESS THAN 100 RPM. 30 SECONDS MAXIMUM CONTINUOUS ACTUATION.
- [4] FLATS TO BE ORIENTED $\pm 5^\circ$ WITH RESPECT TO DATUM A AS SHOWN.
- [5] DESIGNED TO ACCEPT M4 OR #8 SCREW OR EQUIVALENT
6. USER MUST DETERMINE FITNESS FOR USE IN APPLICATION
7. MATERIAL:
BRACKET AND SHAFT END ARE ZINC
SHAFT AND TORQUE ELEMENT ARE HARDENED STEEL

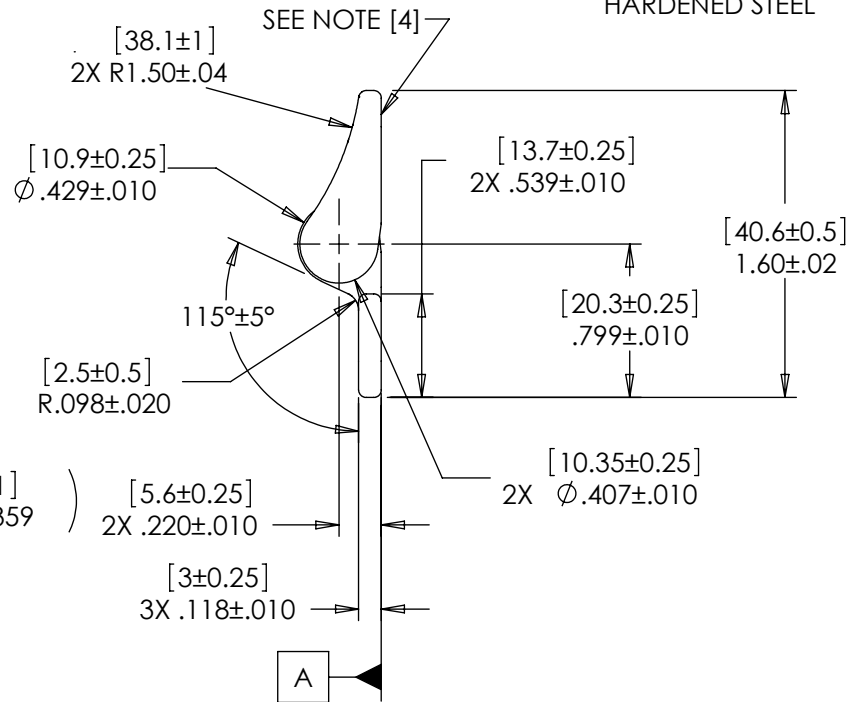
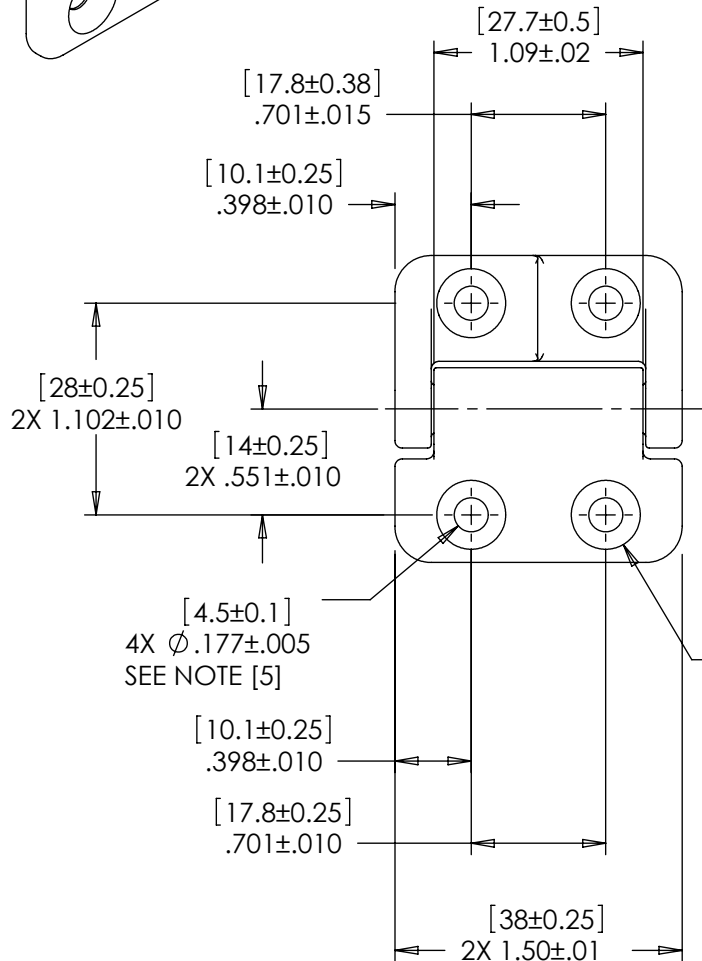
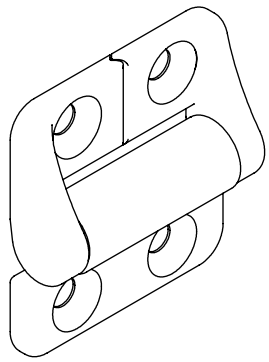

SPECIFICATIONS SUBJECT TO CHANGE

INTERPRET PRINT PER
ASME Y14.5M-1994
THIS PRINT IS THE
CONFIDENTIAL PROPERTY
OF REELL PRECISION MFG.
THIRD ANGLE PROJECTION

| LEVEL | DESCRIPTION | DRAWN | DATE | APPROVED |
|--|-------------|-------|---------|---|
| DRAWN: | HMA | DATE: | 3-1-02 | PART NO: 28-XXX TITLE: POSITIONING HINGE DESCRIPTION: PHC SERIES WITH COUNTERSINKS SCALE: 1:1 |
| CHECKED: | HMA | DATE: | 3-1-02 | |
| APPROVED: | TWJ | DATE: | 3-14-02 | |
| REVISED: | 12-18-13 | DIMS: | [mm]IN | |
| REELL PRECISION MANUFACTURING 1259 WILLOW LAKE BOULEVARD SAINT PAUL, MINNESOTA 55110-5103, USA | | REV: | K | SHEET 1 OF 1 |