

TORQUE [mm] INCHES	PHCS PART NO.
[0.44 Nm] 3.9 Lb-in	81001-504
[0.78 Nm] 6.9 Lb-in	81001-508
[1.22 Nm] 10.8 Lb-in	81001-512
[1.57 Nm] 13.9 Lb-in	81001-516
[2.01 Nm] 17.8 Lb-in	81001-520
[2.35 Nm] 20.8 Lb-in	81001-524
[2.79 Nm] 24.7 Lb-in	81001-530

- NOTES:
- TORQUE TOLERANCE: ± 20%.
 - LIFE: 50,000 CYCLES WHEN DUTY CYCLE IS LESS THAN 10% AND ROTATIONAL SPEED IS LESS THAN 100 RPM. 30 SECONDS MAXIMUM CONTINUOUS ACTUATION.
 - BRACKET FLATS TO BE ORIENTED ± 5° WITH RESPECT TO DATUM A AS SHOWN.
 - DESIGNED TO ACCEPT M4 OR #8 SCREW OR EQUIVALENT.
 - USER MUST DETERMINE FITNESS FOR USE IN APPLICATION.
 - MATERIAL: 316 STAINLESS STEEL.

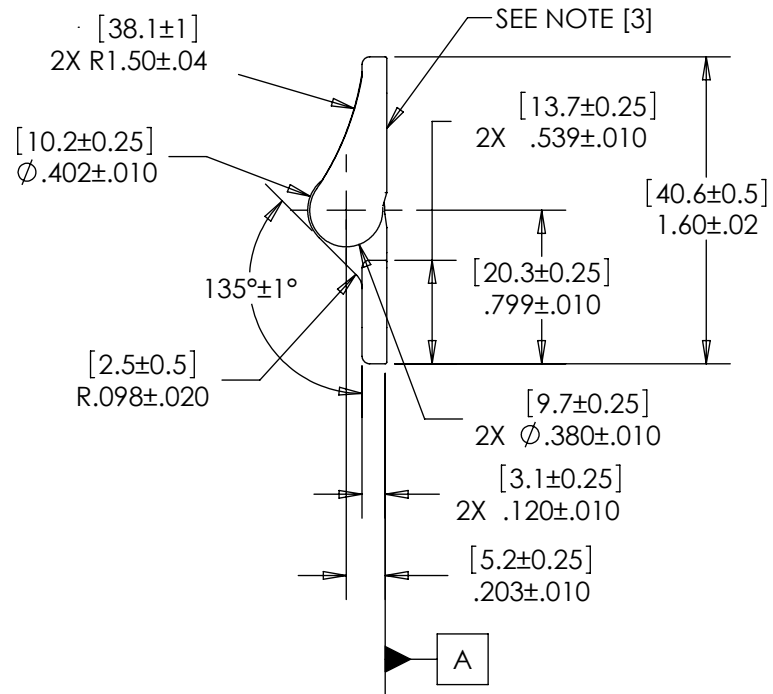
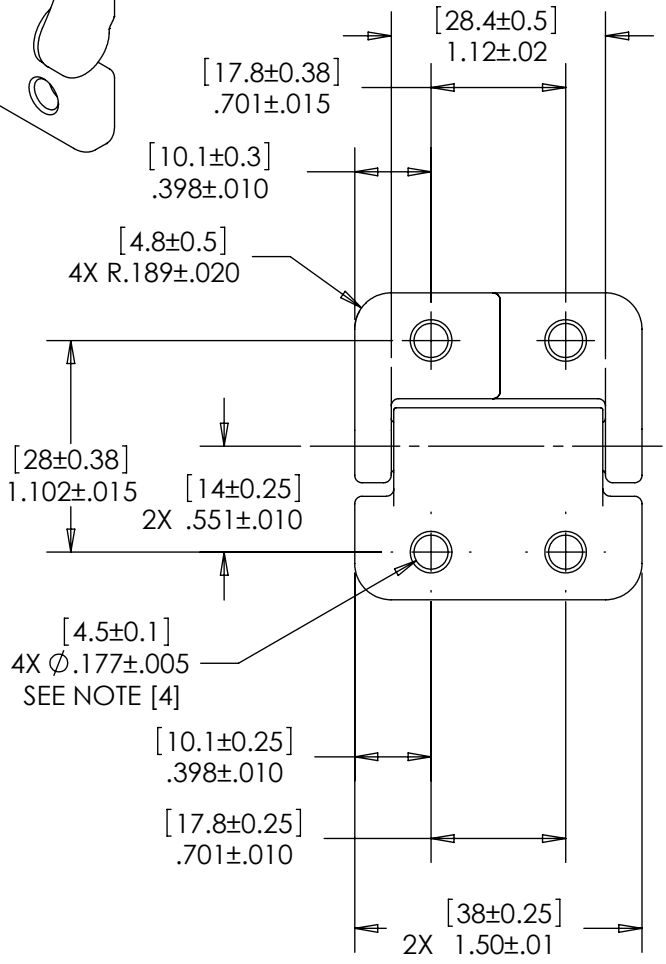
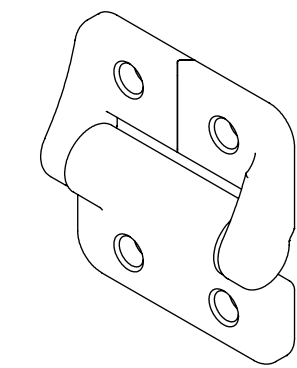

SPECIFICATIONS SUBJECT TO CHANGE

LEVEL	DESCRIPTION	DRAWN	DATE	APPROVED
DRAWN:	TLS	DATE:	24AUG10	PART NO:
CHECKED:	TWJ	DATE:	24AUG10	81001-5XX
APPROVED:	TWJ	DATE:	24AUG10	TITLE:
REVISED:	22APR14	DIMS:	[mm] IN	STAINLESS STEEL HINGE
DESCRIPTION:				REV:
PHCS SERIES				D
SCALE: 1:1		DO NOT SCALE DRAWING		SHEET 1 OF 1

INTERPRET PRINT PER ASME Y14.5M-1994
 THIS PRINT IS THE CONFIDENTIAL PROPERTY OF REELL PRECISION MFG.
 THIRD ANGLE PROJECTION



REELL PRECISION MANUFACTURING
 1259 WILLOW LAKE BOULEVARD
 SAINT PAUL, MINNESOTA 55110-5103, USA