

TORQUE [mm] INCHES	PHCS PART NO.
[0.44 Nm] 3.9 Lb-in	81001-004
[0.78 Nm] 6.9 Lb-in	81001-008
[1.22 Nm] 10.8 Lb-in	81001-012
[1.57 Nm] 13.9 Lb-in	81001-016
[2.01 Nm] 17.8 Lb-in	81001-020
[2.35 Nm] 20.8 Lb-in	81001-024
[2.79 Nm] 24.7 Lb-in	81001-030

- NOTES:
- TORQUE TOLERANCE: ± 20%.
 - LIFE: 50,000 CYCLES WHEN DUTY CYCLE IS LESS THAN 10% AND ROTATIONAL SPEED IS LESS THAN 100 RPM. 30 SECONDS MAXIMUM CONTINUOUS ACTUATION.
 - BRACKET FLATS TO BE ORIENTED ± 5° WITH RESPECT TO DATUM A AS SHOWN.
 - DESIGNED TO ACCEPT M4 OR #8 SCREW OR EQUIVALENT.
 - USER MUST DETERMINE FITNESS FOR USE IN APPLICATION.
 - MATERIAL: 316 STAINLESS STEEL.

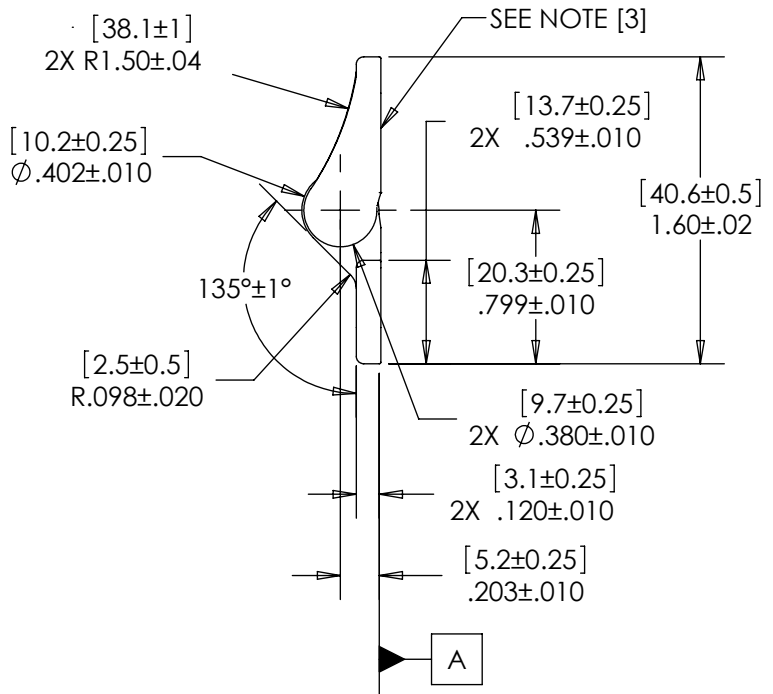
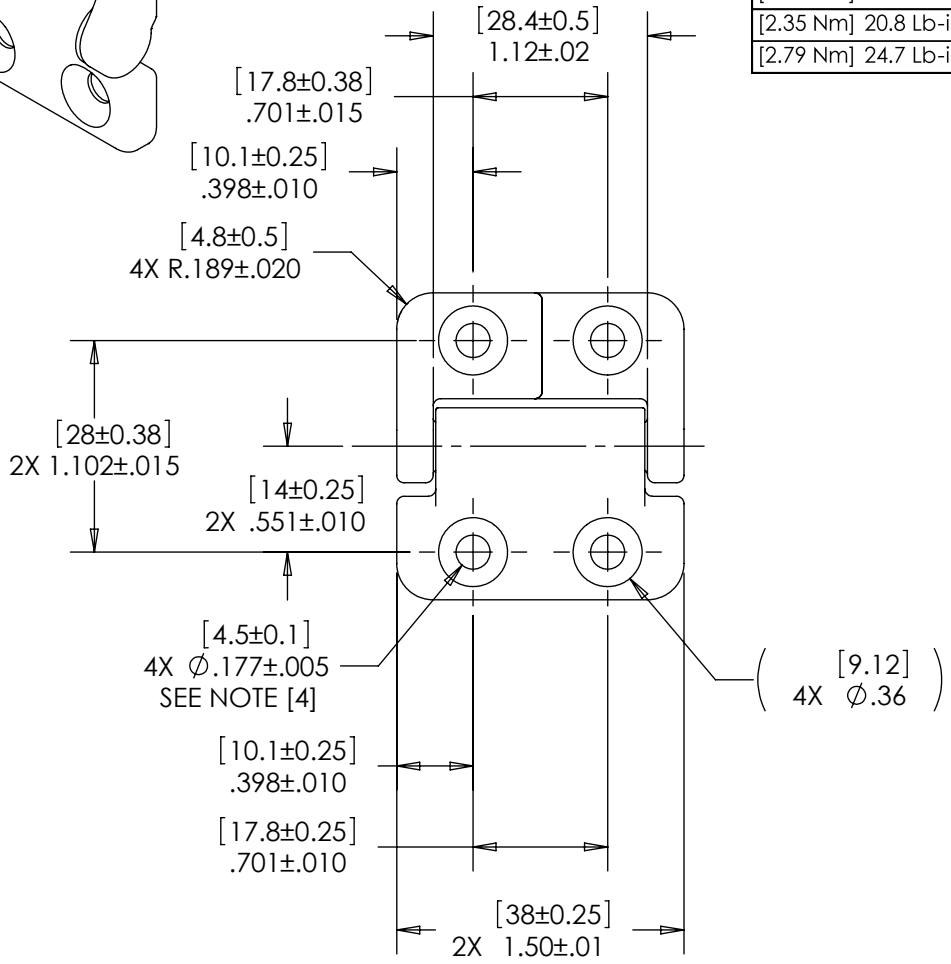

SPECIFICATIONS SUBJECT TO CHANGE

INTERPRET PRINT PER ASME Y14.5M-1994
 THIS PRINT IS THE CONFIDENTIAL PROPERTY OF REELL PRECISION MFG.
 THIRD ANGLE PROJECTION

LEVEL	DESCRIPTION	DRAWN	DATE	APPROVED
DRAWN: JDR	DATE: 1-22-09	PART NO: 81001-0XX		
CHECKED: TWJ	DATE: 1-23-09	TITLE: STAINLESS STEEL HINGE		
APPROVED: TWJ	DATE: 1-23-09	DESCRIPTION: PHCS SERIES WITH COUNTERSINKS		
REVISED: 4-22-14	DIMS: [mm] IN	REV: E		
REELL PRECISION MANUFACTURING 1259 WILLOW LAKE BOULEVARD SAINT PAUL, MINNESOTA 55110-5103, USA		SCALE: 1:1	DO NOT SCALE DRAWING	SHEET 1 OF 1