

8 7 6 5 4 3 2 1

NOTES: 1.

TORQUE	PLAIN
[INCHES] mm	PART NO.
[3.9] Lb-in 0.44 Nm	83736-004
[6.9] Lb-in 0.78 Nm	83736-008
[10.8] Lb-in 1.22 Nm	83736-012
[13.9] Lb-in 1.57 Nm	83736-016
[17.8] Lb-in 2.01 Nm	83736-020
[20.8] Lb-in 2.35 Nm	83736-024
[24.7] Lb-in 2.79 Nm	83736-030

2. TORQUE TOLERANCE: $\pm 20\%$
3. LIFE: 50,000 CYCLES WHEN DUTY CYCLE IS LESS THAN 10% AND ROTATIONAL SPEED IS LESS THAN 100 RPM. 30 SECONDS MAXIMUM CONTINUOUS ACTUATION.
- [4] FLATS TO BE ORIENTED $\pm 5^\circ$ WITH RESPECT TO DATUM A AS SHOWN.
- [5] DESIGNED TO ACCEPT M4 OR #8 SCREW OR EQUIVALENT
6. USER MUST DETERMINE FITNESS FOR USE IN APPLICATION
7. MATERIAL:
 BRACKET AND SHAFT ENDS ARE ALUMINUM
 BUSHING PLASTIC
 SHAFT AND TORQUE ELEMENT ARE HARDENED STEEL

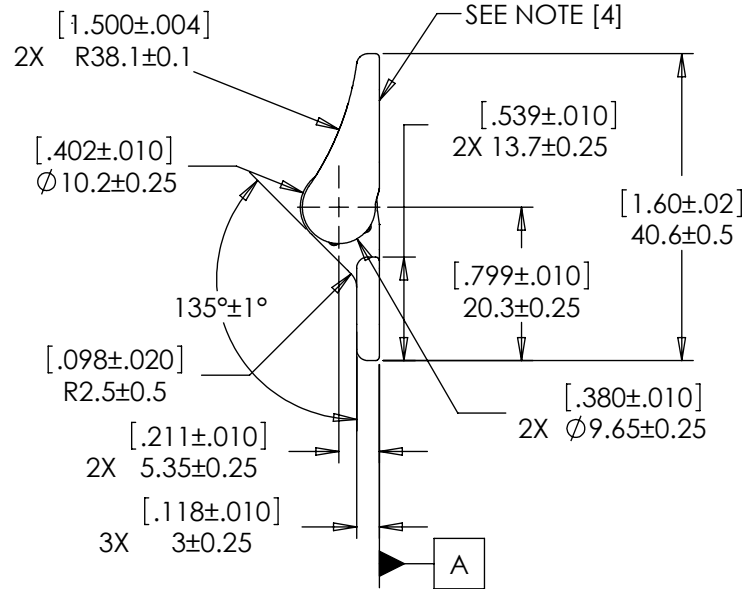
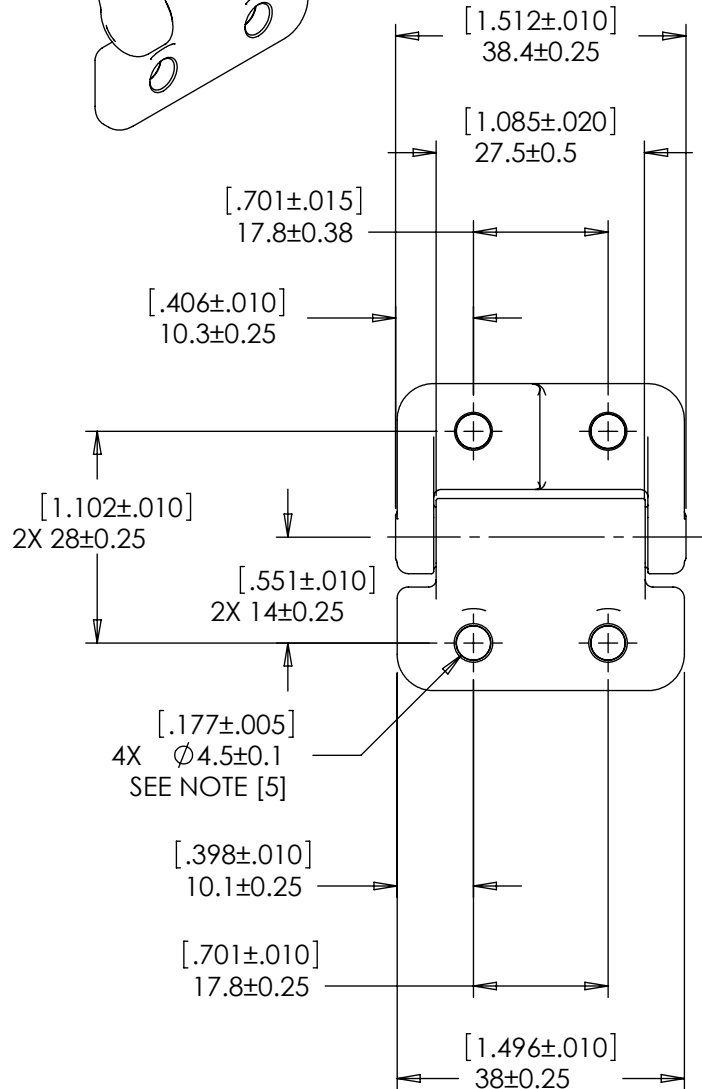
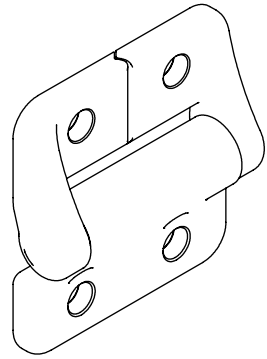

LEVEL	DESCRIPTION	DRAWN	DATE	APPROVED
DRAWN:	HMA	DATE:	31OCT12	PART NO: 83736-XXX
CHECKED:	GDL	DATE:	21NOV12	
APPROVED:	GDL	DATE:	21NOV12	
REVISED:	30APR13	DIMS:	[IN]mm	
TITLE: POSITIONING HINGE				
DESCRIPTION: PHCA SERIES				REV: A
SCALE: 1:1		DO NOT SCALE DRAWING		SHEET 1 OF 1

INTERPRET PRINT PER ASME Y14.5M-1994
 THIS PRINT IS THE CONFIDENTIAL PROPERTY OF REELL PRECISION MFG.
 THIRD ANGLE PROJECTION

REELL
 REELL PRECISION MANUFACTURING
 1259 WILLOW LAKE BOULEVARD
 SAINT PAUL, MINNESOTA 55110-5103, USA

SPECIFICATIONS SUBJECT TO CHANGE

8 7 6 5 4 3 2 1