

NOTES:

1. DYNAMIC TORQUE AND PART NUMBERS SEE PAGE 2.
2. LIFE: 20,000 CYCLES.
ONE CYCLE = 90° OPEN/90° CLOSED.
FIVE(5) CYCLES PER MINUTE MAX.
3. MATERIAL:
CENTER BRACKET: ENGINEERED PLASTIC
OUTER BRACKET: ENGINEERED PLASTIC
SHAFT: HARDENED STEEL
TORQUE ELEMENT: HARDENED STEEL
BEARINGS: HARDENED STEEL
BEARING CAPS: DIE CAST ZINC
4. DESIGNED TO ACCEPT M6 OR 1/4" BUTTON HEAD SCREW OR EQUIVALENT.
- [5] BRACKET TO BE ORIENTED ±10° WITH RESPECT TO DATUM A AS SHOWN.
6. TOTAL TRAVEL 270°.
7. STATIC TORQUE IS NORMALLY WITHIN 10% OF DYNAMIC TORQUE.
- [8] DIRECTION DETERMINED WITH CENTER BRACKET FIXED AND OUTER BRACKET ROTATED AS SHOWN.
9. USER MUST DETERMINE FITNESS FOR USE IN APPLICATION.
- [10] HINGE SHIPPED WITH PLASTIC CLIP INSTALLED TO PREVENT ROTATION IN LOW TORQUE DIRECTION.

NAME: MH - 18 - X.X - X

| TORQUE Nm |
|-----------|
| 4.0 |
| 6.0 |
| 8.0 |

| TYPE |
|---------------------|
| F - ONE WAY FORWARD |
| R - ONE WAY REVERSE |

| LEVEL | DESCRIPTION | DRAWN | DATE | APPROVED |
|---|-------------|--|---------|---|
| DRAWN: | MPG | DATE: | 11FEB16 | REFERENCE: 18-XXX TITLE: MOLDED HINGE ASSEMBLY PART NO: MH18 SERIES |
| CHECKED: | MPG | DATE: | 21JUN16 | |
| APPROVED: | MPG | DATE: | 21JUN16 | |
| REVISED: | 19DEC17 | DIMS: | mm | |
| | | | | |
| INTERPRET PRINT PER ASME Y14.5M-1994 THIS PRINT IS THE CONFIDENTIAL PROPERTY OF REELL PRECISION MFG. THIRD ANGLE PROJECTION | | REELL PRECISION MANUFACTURING 1259 WILLOW LAKE BOULEVARD SAINT PAUL, MINNESOTA 55110-5103, USA | | REV: C |
| SCALE: 1:2 | | DO NOT SCALE DRAWING | | SHEET 1 OF 2 |

SPECIFICATION SUBJECT TO CHANGE

| CATALOG NUMBER | TYPE | DYNAMIC TORQUE FORWARD DIRECTION | | DYNAMIC TORQUE REVERSE DIRECTION | |
|----------------|-----------------|----------------------------------|-----------|----------------------------------|-----------|
| | | NOMINAL | TOLERANCE | NOMINAL | TOLERANCE |
| | | Nm | +/- % | Nm | +/- % |
| MH-18-4.0-F | ONE WAY FORWARD | 4.0 | 25 | 1.8 | MAX |
| MH-18-4.0-R | ONE WAY REVERSE | 1.8 | MAX | 4.0 | 25 |
| MH-18-6.0-F | ONE WAY FORWARD | 6.0 | 20 | 1.8 | MAX |
| MH-18-6.0-R | ONE WAY REVERSE | 1.8 | MAX | 6.0 | 20 |
| MH-18-8.0-F | ONE WAY FORWARD | 8.0 | 20 | 1.8 | MAX |
| MH-18-8.0-R | ONE WAY REVERSE | 1.8 | MAX | 8.0 | 20 |

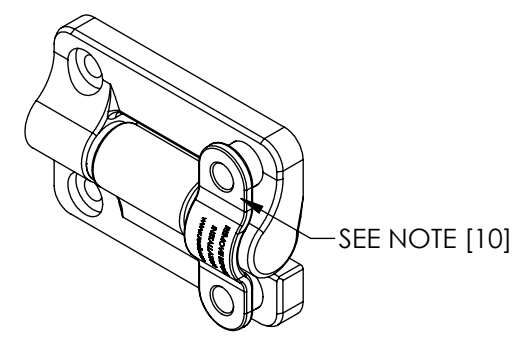
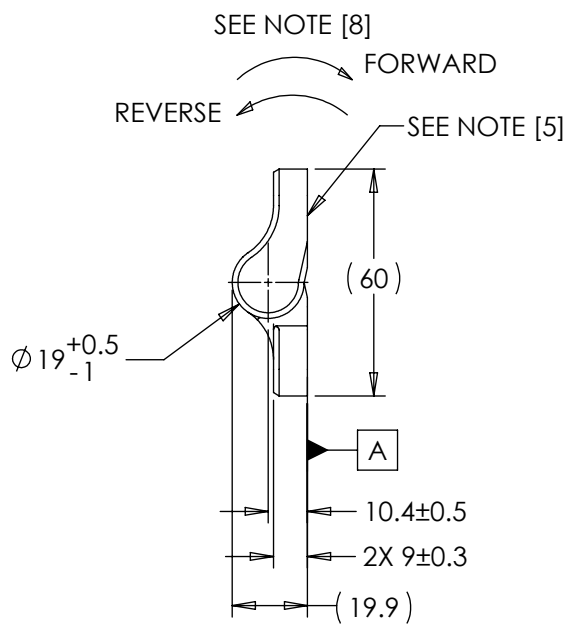
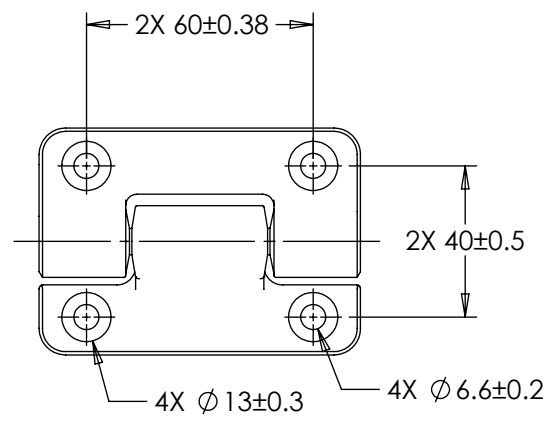
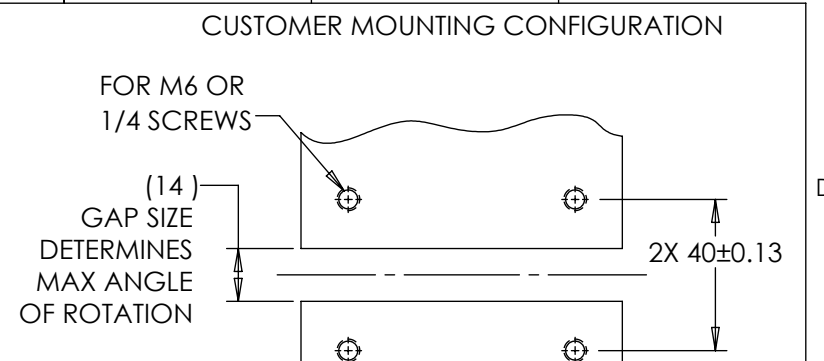

NOTE: MOUNT OPEN HOLES WITH SNUG FIT BEFORE REMOVING THE PLASTIC CLIP.

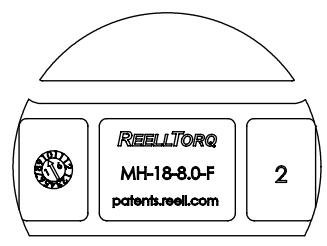
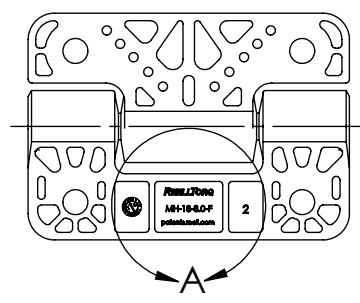
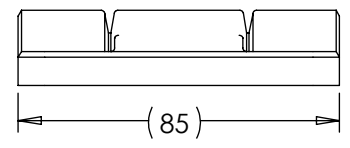

DETAIL A
SCALE 1 : 1

INTERPRET PRINT PER ASME Y14.5M-1994
THIS PRINT IS THE CONFIDENTIAL PROPERTY OF REELL PRECISION MFG.
THIRD ANGLE PROJECTION

| LEVEL | DESCRIPTION | DRAWN | DATE | APPROVED |
|-----------|-------------|--|---------|---|
| DRAWN: | MPG | DATE: | 11FEB16 | REFERENCE: 18-XXX TITLE: MOLDED HINGE ASSEMBLY PART NO: MH18 SERIES SCALE: 1:2 |
| CHECKED: | MPG | DATE: | 21JUN16 | |
| APPROVED: | MPG | DATE: | 21JUN16 | |
| REVISED: | 19DEC17 | DIMS: | mm | |
| | | REELL PRECISION MANUFACTURING 1259 WILLOW LAKE BOULEVARD SAINT PAUL, MINNESOTA 55110-5103, USA | | REV: C |
| | | DO NOT SCALE DRAWING | | SHEET 2 OF 2 |

SPECIFICATION SUBJECT TO CHANGE