

1 2 3 4

LINEAR SPECIFICATIONS:

LINEAR STROKE: 10 +/-0 mm
 PEAK FORCE: 1.5N @ 24Vdc (1.5A)
 FORCE CONSTANT: 1.0 N/A N/A
 ENCODER RESOLUTION: 5, 1, 0.1 μm
 ENCODER REPEATABILITY: ± 2μm
 MOVING MASS: 10 grams
 TOTAL MASS: 0.080 kg

OPERATING TEMPERATURE: 0°C TO 65°C
 ALL DIMENSIONS ARE IN mm

REVISION HISTORY			
REV	DATE	ECN	DESCRIPTION
F	10/7/2014		PART #
G	10/23/2014	5491	NEW PART #

APPROVED
TMV

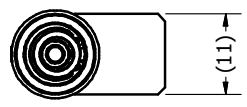
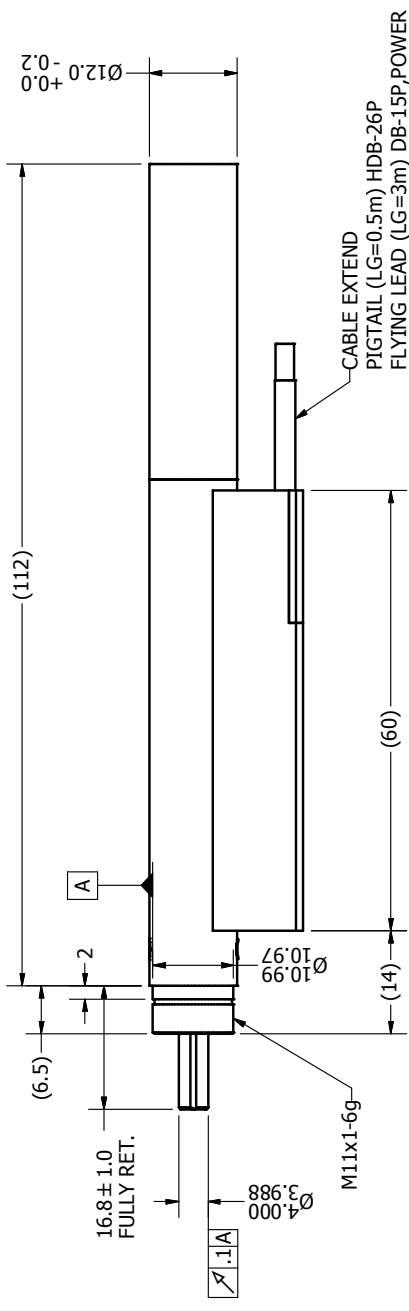

DB-26P PINOUT

1	(AXIS 1) PH. A+
2	(AXIS 1) PH. B+
3	(AXIS 1) PH. Z+
4	NC
5	NC
6	IO RTN
7	NC
8	NC
9	NC
10	(AXIS 1) PH. A-
11	(AXIS 1) PH. B-
12	(AXIS 1) PH. Z-
13	NC
14	NC
15	NC
16	NC
17	NC
18	NC
19	+5VDC
20	5V RTN
21	(AXIS 1) COIL +
22	(AXIS 1) COIL -
23	(AXIS 1) COIL -
24	(AXIS 1) COIL -
25	NC
26	NC

DB-15

PIN No.	FUNCTION
1	PH. A+
2	PH. Z+
3	PH. B+
4	+5V
5	NC
6	NC
7	NC
8	NC
9	PH. A-
10	PH. Z-
11	PH. B-
12	5V RTN

POWER	
No	DETAIL
1	V RTN
2	+V
3	COIL +
4	COIL -

TOLERANCES ARE:	X. ± 0.50	MATERIAL:	REF. NUMBER	CA12-010
X.X ± 0.1		HEAT TREATMENT:	DESIGNED BY:	10ARTVU
X.XX ± 0.05			CHECKED BY:	
X.XXX ± 0.1*			DATE:	9/28/2009
ANGULARITY ± 0.1*			DATE:	10/7/2014
CONCENTRIC ± 0.01			APPROVED BY:	
ROUNDNESS ± 0.05			DATE:	
EDGE BREAK 0.02 MAX			PART NAME:	CAL12-010-51-1
CHAMFER 0.03 MAX			DWG SIZE:	B
FILE NAME:	CAL12-010-51-1.iDW		SCALE:	NONE
			DO NOT SCALE DWG	
			SHEET NUMBER:	1 OF 1
			REVISION:	G

SMAC

1 2 3 4